

119 avenue d'Ivry

75013 Paris
floor 1 out of 7
189.88 sqft
17.64 sqm
available from now on

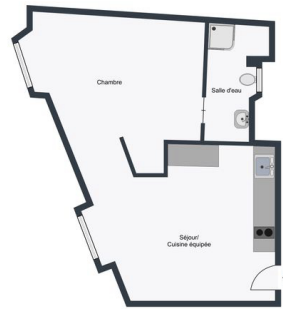

+33 7 85 99 37 74

rent

base rent	EUR 601
additional rent	EUR 340
operational costs	EUR 70
total rent	EUR 1 011
deposit	EUR 941
rent increase	34,1 EUR / sqm
reference	

apartment

flooring	parquet
store room	
built-in kitchen	
dishwasher	
washing machine	

building

construction year	1900
-------------------	------

energy

energy efficiency rating E	
date of certificate	17/03/2026
current energy consumption	318 kWh/m ² *a
gas efficiency rating B	
current gas consumption	12 kgeqCO ₂ /m ²



min annual energy
consumption cost EUR 610
max annual energy
consumption cost EUR 840
energy
consumption 01/01/2021
reference date

distance, meters

closest subway
station Tolbiac



